

Dimple Flush Mount

Ceiling Flush Mounts



50 Greene St
New York NY 10013
T +1 212 388 1621
sales@rbw.com



For 2D & 3D drawings of all products, including CAD, Revit and IES files, please visit rbw.com

DESCRIPTION

Originally designed in collaboration with Sister City, Dimple is a compact and dimmable, flush-mounted sconce that casts a diffuse and soft, atmospheric light. It is cheekily named for the thick, domed circular diffuser embedded into its front face.

MATERIALS

Cast solid glass, aluminum

COLLECTION NOTES

Luminaire lumens listed are for AC input Triac control. DC input are within photometry downloads.

PERFORMANCE

280 lumens (Frosted) | 240 lumens (White) | 120 lumens (Smoke) | 164 lumens (Amber)

Power Consumption 8.5W

Luminaire Watts 7.3W (AC Input)

38 lm/w (Frosted) | 33 lm/w (White) | 17 lm/w (Smoke) | 23 lm/w (Amber)

90 CRI

LED LIFESPAN

50k hours

CERTIFICATION

ADA Compliant

UL Listed

Suitable for Wet Locations

Suitable for Damp Locations

IP20

IP65

**PRODUCT DIMENSIONS**

5" Dia. x 3" Depth

PRODUCT WEIGHT

3 lbs / 1.63 kg

DIMENSIONAL WEIGHT

2 lbs

YOUR PRODUCT CODE

DP-FM-S3-AA01-27-10_TRIAC_120V-IP20

Specification Logic

GLASS FINISH

Amber	S3
Frosted	S4
Smoked	S2
White Interior	S1

BACKPLATE FINISH

Natural Anodized	AA01
Black Anodized	AA04

COLOR TEMPERATURE

2700K (warm white)	27
3000K (soft white)	30
3500K (neutral white)	35

DIMMING / CONTROL / INPUT

Low Voltage (Driver required, driver not included)	LV
10% Dimming, TRIAC / Forward Phase Control, 120V Input	10_TRIAC_120V
1% Dimming, 0-10V Control, 120V or 277V "Universal Input"	1_10V_UNV
1% Dimming, TRIAC / Forward Phase Control, 120V Input	1_TRIAC_120V
0.1% Dimming, 0-10V Control, 120V or 277V "Universal Input"	0.1_10V_UNV

IP RATING

IP 20	IP20
IP 65	IP65

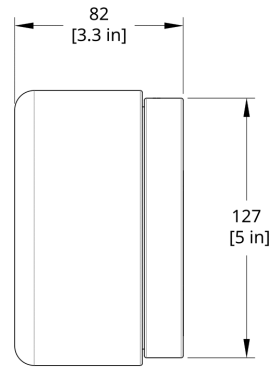
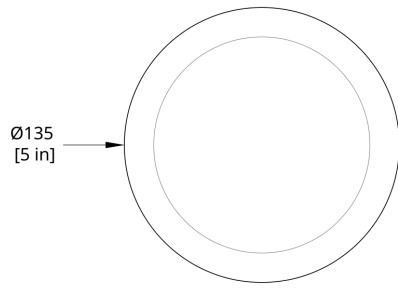

DP-WS Dimple Sconce Dimension (Rotate 90 degrees for flush mount version)