

Materials Parchment lampshade with hand-stitched leather lace
Hand-finished brass hardware

Dimensions 10 in (25.4cm) W x 5 3/16 in (13.2cm) D x 16 1/2 in (41.9cm) H

Backplate 16 3/8" H x 3/16" D
j-box location indicated off center

Lamping 2 x E26 sockets
G16.5 LED bulbs (not provided)
3.8W 2700K
350 lm

Finishes ● Satin Brass

● Polished Brass

● Silver Patina

Shade ● Parchment Paper

● Parchment Hide



Handmade in Los Angeles

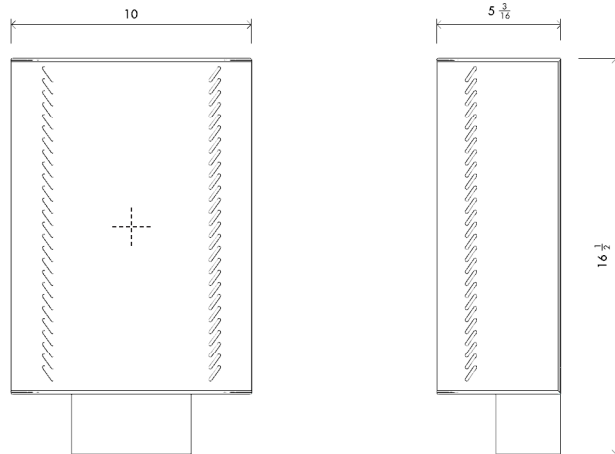

Bulb life	15,000 hrs
Dimming	10-100%. Wattage +/- 10% Lumen Values +/- 5Lms CRI +/- 5% Fully tested with LUTRON® DVCL, DVEL
Voltage	120 V / 240
Certification	UL, CE listed
Type	Hardwired (plug-In available upon request)

Materials Parchment lampshade with hand-stitched leather lace
Hand-finished brass hardware

Dimensions 15 1/2 in (39.4cm) W x 6 in (15.2cm) D x 10 1/2 in (26.7cm) H

Backplate 10 3/8" H x 3/16" D
j-box location indicated off center

Lamping 2 x E26 sockets
G16.5 LED bulbs (not provided)
3.8W 2700K
350 lm

Finishes

- Satin Brass
- Polished Brass
- Silver Patina

Shade

- Parchment Paper
- Parchment Hide



Handmade in Los Angeles

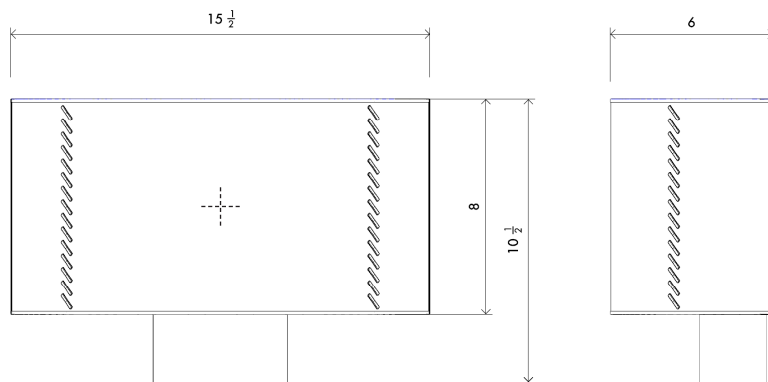

Bulb life 15,000 hrs

Dimming 10-100%. Wattage +/- 10%
Lumen Values +/- 5Lms
CRI +/- 5%
Fully tested with LUTRON® DVCL, DVEL

Voltage 120 V / 240

Certification UL, CE listed

Type Hardwired
(plug-in available upon request)